

FILED

COUNTY COUNCIL

07 NOV -7 AM 11:38

OF

DORCHESTER COUNTY, MARYLAND

2007 Legislative Session,
Legislative Day No. November 6, 2007

Introduced By: County Council

BILL NO. 2007-10

AN ACT OF THE COUNTY COUNCIL OF DORCHESTER COUNTY, MARYLAND PURSUANT TO SECTION 40-20 OF CHAPTER 40 OF THE DORCHESTER COUNTY CODE CLOSING THE TWENTY-ONE (21) FOOT PORTION OF AN OLD COUNTY PUBLIC ROAD LOCATED SOUTH OF HUDSON ROAD (MARYLAND STATE ROUTE 343), CROSSING THE PROPERTY OF BERNADINE CHESTER, DORCHESTER COUNTY TAX MAP 18, GRID 18, PARCEL 157, DEED REFERENCES 201/206 AND 203/514.

Introduced, read first time, ordered posted on the official bulletin board of County, County Office Building, 501 Court Lane, Cambridge, Maryland 21613.

Ordered publication for once a week for two (2) successive weeks, and public hearing scheduled on Tuesday, November 6, 2007, Room 110, County Office Building, 501 Court Lane, Cambridge, Maryland at 6:50 p.m.

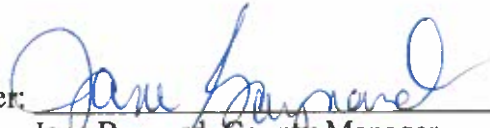
By order: 
Jane Baynard, County Manager

BILL NO. 2007-10

AN ACT OF THE COUNTY COUNCIL OF DORCHESTER COUNTY, MARYLAND PURSUANT TO SECTION 40-20 OF CHAPTER 40 OF THE DORCHESTER COUNTY CODE CLOSING THE TWENTY-ONE (21) FOOT PORTION OF AN OLD COUNTY PUBLIC ROAD LOCATED SOUTH OF HUDSON ROAD (MARYLAND STATE ROUTE 343), CROSSING THE PROPERTY OF BERNADINE CHESTER, DORCHESTER COUNTY TAX MAP 18, GRID 18, PARCEL 157, DEED REFERENCES 201/206 AND 203/514.

SECTION ONE: Acting under Article 25 A, Section 5 (B) and Section 5 (S) of The Annotated Code of Maryland (the "Acts"), be it ENACTED and ORDAINED by the County Council of Dorchester County, Maryland that the twenty-one (21) foot portion of an Old County Public Road located south of Hudson Road (Maryland State Route 343), crossing the property of Bernadine Chester, Dorchester County Tax Map 18, Grid 18, Parcel 157, deed references 201/206 and 203/514, be and the same is hereby closed. That portion of the twenty-one (21) foot wide road being closed is shown and laid down as "Old County Road" on the attached Exhibit A, incorporated herein by reference.

SECTION TWO: Be it further ENACTED and ORDAINED by the County Council of Dorchester County, Maryland that the President of the County Council be and he is hereby authorized and empowered on behalf of Dorchester County, Maryland to execute any requested Quit-Claim deeds, without a warranty of title, to the abutting property owners, all at the expense of the abutting property owners, and the County Manager is hereby authorized to attest and seal the President's execution of any Quit-Claim deeds relating to the closing of the road.

SECTION THREE: Be it further ENACTED and ORDAINED by the County Council of Dorchester County, Maryland that this Bill shall be known as Bill No. 2007- 10 of Dorchester County, Maryland and shall take effect sixty (60) days after its final passage.

PASSED this 6th day of November, 2007.

ATTEST:

COUNTY COUNCIL OF DORCHESTER COUNTY, MARYLAND

BY: Jane Baynard
Jane Baynard, County Manager

BY: William V. Nichols
William V. Nichols, President

APPROVED this 6th day of November, 2007.

ATTEST:

COUNTY COUNCIL OF DORCHESTER COUNTY, MARYLAND

BY: Jane Baynard
Jane Baynard, County Manager

BY: William V. Nichols
William V. Nichols, President

Nichols – Aye
Newcomb – Aye
Elzey – Aye
Price – Aye
Travers – Aye

cd2:Oct.07
DorCo.BILL2/mlh



EXHIBIT A

S T A T E R O A D .

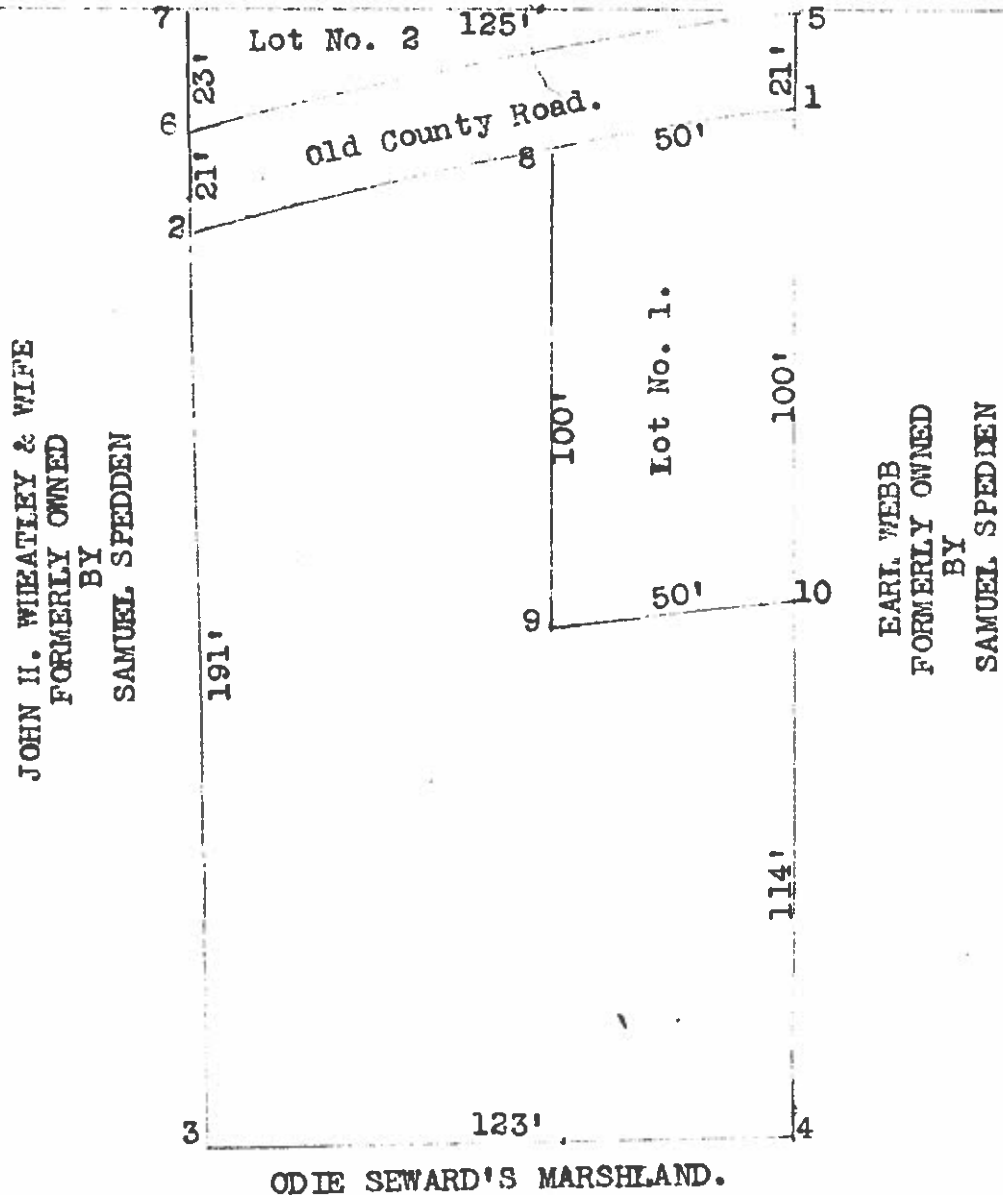

EXPLANATION:-

Lot No. 3, enclosed by figures 1, 2, 3 & 4 is original John R. Ennalls lot.

Lot No. 2, enclosed by the figures 5, 6 & 7 is part of the Rambo lands.

Lot No. 1, enclosed by the figures 1, 8, 9 & 10 is the lot conveyed by John R. Ennalls to John W. Ennalls.

SCALE: 40 feet equals 1 inch.